

Top View

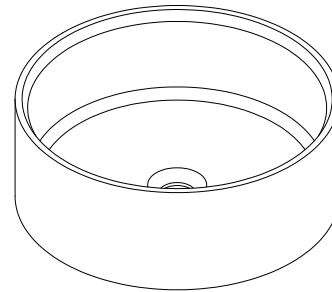

Isometric View

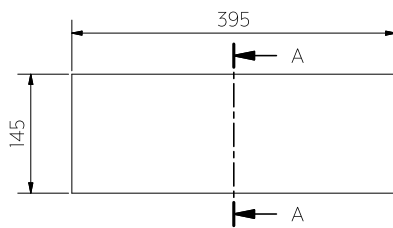

Front View

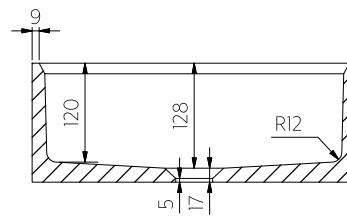

Section View A-A

**Note:** Dimensions are nominal measurements only

## SPECIFICATIONS

RECOMMENDED USE Domestic

MATERIAL Concrete

INSTALLATION Bench Mount

OVERFLOW No

CAPACITY 12.7L

RIM THICKNESS 9mm

# INSTALLATION GUIDE

Note: This product must be installed by a licensed plumber. This is a general installation guide - there are many factors involved that can alter the installation method. AU/NZ: For installations within Australia and New Zealand, this product must be installed in compliance with AS/NZS 3500. UK: For installations in the United Kingdom this product must be installed in compliance with the Water Supply (Water Fittings) Regulations and Water Supply (Water Fittings) (Scotland) Byelaws. Other: For installations outside these countries, this product must be installed in compliance with the standards in your respective country.

① Use a hole saw to drill a hole in the countertop.

**Note:** If cutting into a stone benchtop it will need to be cut in a controlled environment by a licensed tradesperson as per OH&S regulations

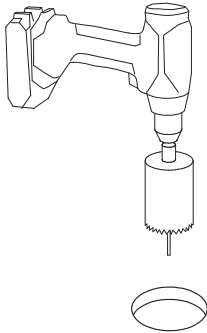

② Install Avi Pop Up Waste, trap and connecting waste pipes.

Apply silicone to the benchtop before placing basin down.

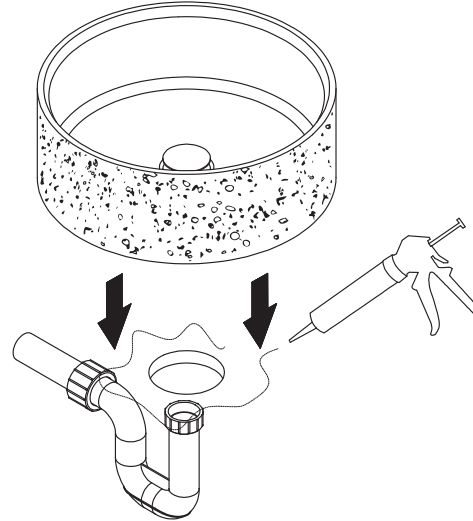

③ Test and commission. Ensure no leaks.

## How to swap lids on your Avi Pop Up Waste (NOT INCLUDED)

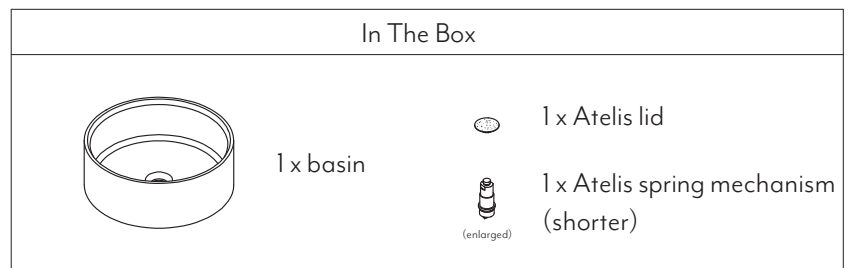
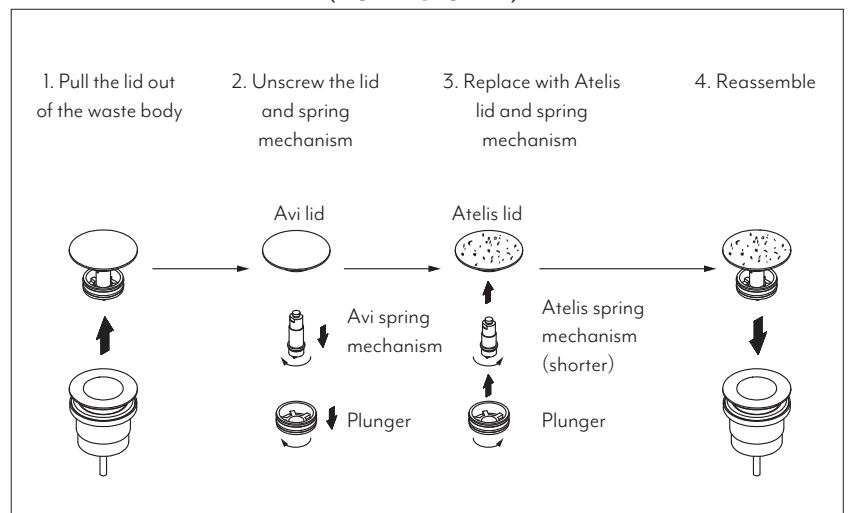
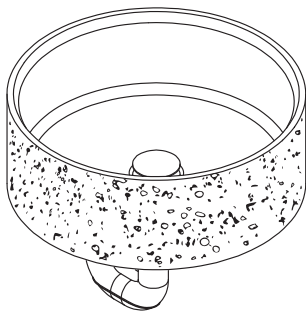

Regularly clean with mild liquid detergent or soap and water



DO NOT use cream cleaners or bleach. These substances are abrasive

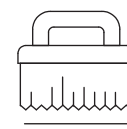

DO NOT use cleaning pads with abrasive surfaces as this may scratch the material

# CLEANING & WAXING GUIDE

Note: It is important to clean your product regularly to prevent build up of soap scum and dirt. The longer it is left uncleaned the more difficult it becomes to clean later.



- ① Wipe clean the basin using a sponge/cloth with warm water mixed with a mild liquid detergent, use a brush to clean the rougher external texture.

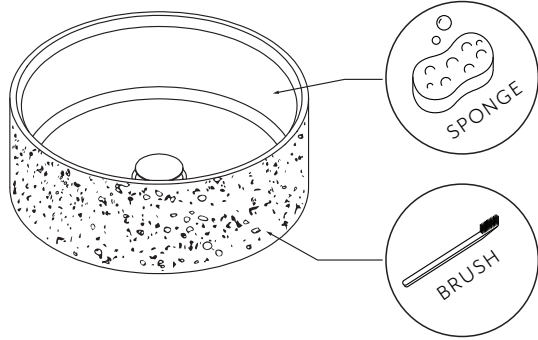

Clean these areas thoroughly

- ② Ensure a clean dry surface before applying wax. Apply using a microfibre cloth.

1. Add a thin layer to the inside of the bowl
2. Allow 5 minutes for the wax to settle
3. Wipe the basin again with the unused side of the cloth to remove excess wax

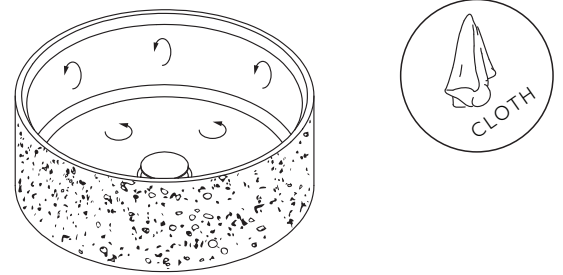

Note: We recommend Gilly's Food Safe Wax

DO USE	DON'T USE
<ul style="list-style-type: none"> <li>- Sponge</li> <li>- Toothbrush</li> <li>- Micro fibre cloth</li> <li>- Mild liquid detergent</li> <li>- Warm water</li> <li>- Natural based cleaners</li> </ul>	<ul style="list-style-type: none"> <li>- Abrasive materials</li> <li>- Steel wool</li> <li>- Pot scourer</li> <li>- Cloth or paper</li> <li>- Acid detergent</li> <li>- Metal objects (eg. screwdrivers)</li> </ul>