

Note: Dimensions are nominal measurements only

SPECIFICATIONS

RECOMMENDED USE

Domestic

INSTALLATION

Suits 40mm Trap

OVERFLOW

Compatible with overflow and non-overflow basins

Disclaimer: Products in this manual must by law be installed by licensed and registered tradespeople in accordance with the relevant standards. ABI and the manufacturer/distributor reserve the right to vary specifications or delete models from their range without prior notification. Dimensions are nominal measurements only. The information listed is correct at the time of publication, however ABI and the manufacturer/distributor takes no responsibility for printing errors. Copyright © ABI Interiors 2021.

INSTALLATION GUIDE

Note: This product must be installed by a licensed plumber. This is a general installation guide - there are many factors that are involved that can alter the installation method. The standards in your respective country must be adhered to by your licensed tradesperson.

- 1 Remove plug & grate by holding top base & pulling plug upwards.

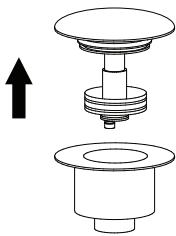

- 2 Fit foam washer to top base and drop fixing bolt into base.

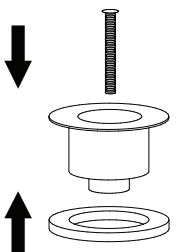

- 3 Place the lower base with silicon washer underneath the basin & tighten fixing bolt with phillips head screw driver.

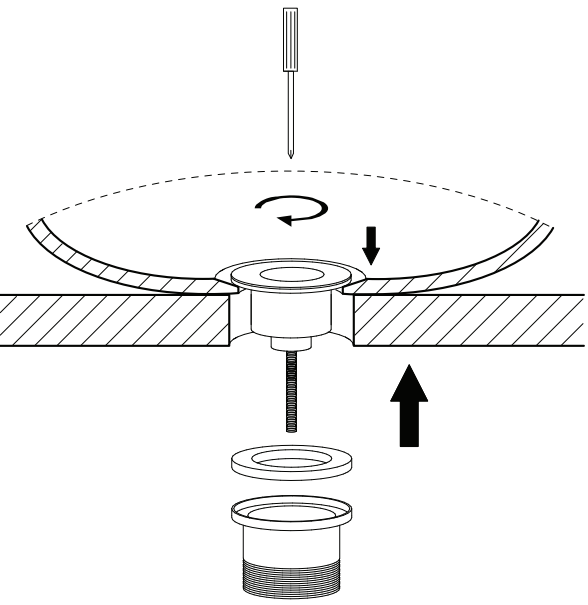

Disassembled pop-up waste components

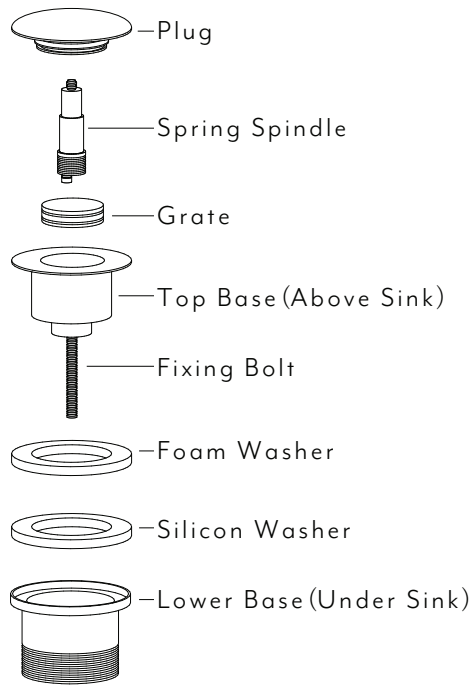

- 4 Re-fit plug & grate into top base. Connect pipe work & test plug mechanism by pressing plug down with running water.

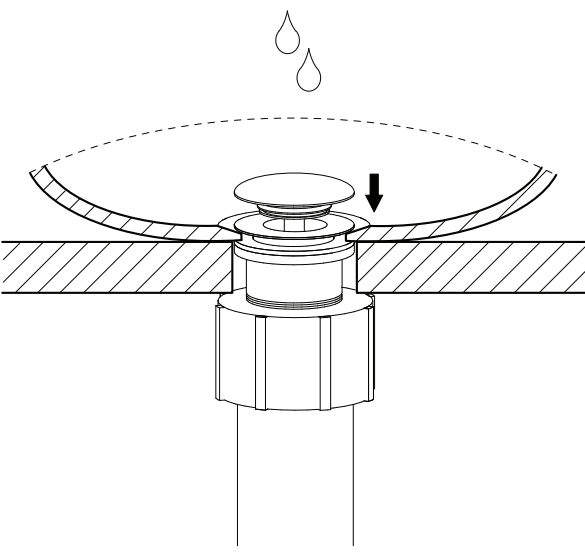

Regularly clean with mild liquid detergent or soap and water.



DO NOT use cream cleaners or bleach. These substances are abrasive.



DO NOT use cleaning pads with abrasive surfaces as this may scratch the material.