

**Note:** Dimensions are nominal measurements only

### SPECIFICATIONS

<b>RECOMMENDED USE</b>	Domestic
<b>PRESSURE RATING</b>	Recommended minimum working pressure 0.2 Bar Recommended maximum working pressure 5 Bar Hot and cold water inlet pressure should be equal
<b>TEMPERATURE RATING</b>	Maximum continuous working temperature 75°C If the water temperature exceeds 75°C, an approved tempering valve must be fitted
<b>SUITABLE HOT WATER UNITS</b>	Storage tank: Yes Continuous Flow: Yes Gravity Feed: Suitable
<b>STANDARDS</b>	Nominal Flow Rate(5.5 L/M) WRAS approved
<b>WARRANTY</b>	Structure: 25 years   Finish: 5 years   Cartridge: 10 years

Disclaimer: Products in this specification manual must by regulation be installed by licensed and registered trade people. The manufacturer/distributor reserves the right to vary specifications or delete models from their range without prior notification. Dimensions are nominal measurements only. Dimensions and set-outs listed are correct at time of publication however the manufacturer/distributor takes no responsibility for printing errors. All ABI Products are designed in Australia. Copyright ABI Interiors 2019.

### INSTALLATION GUIDE

Note: This product must be installed by a licensed tradesperson. This is a general installation guide - there are many factors that are involved that can alter the installation method.

Note: Flow restrictor to be installed when using this product over a basin and paired with a spout. Flow restrictors are provided with the spout

1 Fasten screws to secure the shower mixer assembly in place.

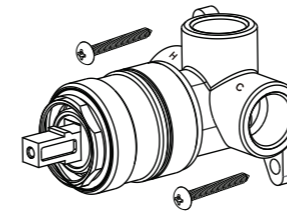

2 Attach water supply and water outlet. TEST AND CHECK FOR LEAKS

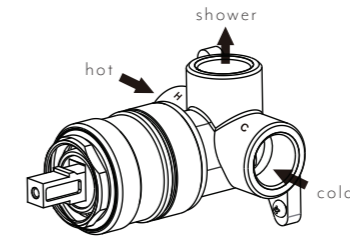

3 Create a 45mm round hole in cement sheet and tiles

Push the sleeve over the body until it is as far back as possible. Screw the dome onto the brass fitting and tighten

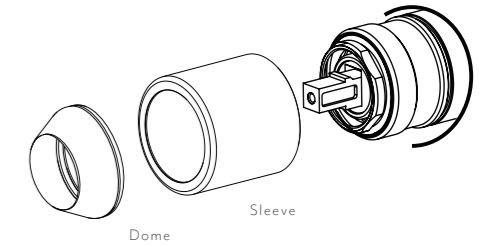

\*Please ensure that the hole is big enough to allow for the sleeve to slide on at fit-off stage\*

4 Assemble the plate and fix it in place.

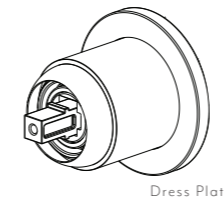

5 Place the handle onto the fitting. Fasten the grub screw firmly with the allen key

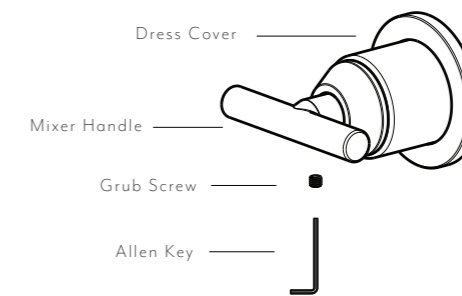

#### PROGRESSIVE MIXER OPERATION

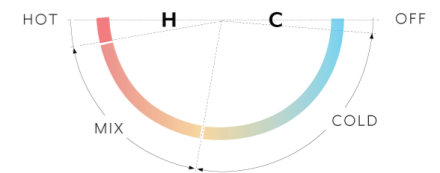

### HOW TO CUSTOMIZE YOUR MIXER

STEP 1: Visit our online shop or go in-store to purchase your new Handle Kit - Be sure to check the mixer type before you purchase!

STEP 2: Remove the handle, dome and sleeve from your mixer & repeat steps above for installation!

STEP 3: Be sure to get this checked by your plumber prior to using

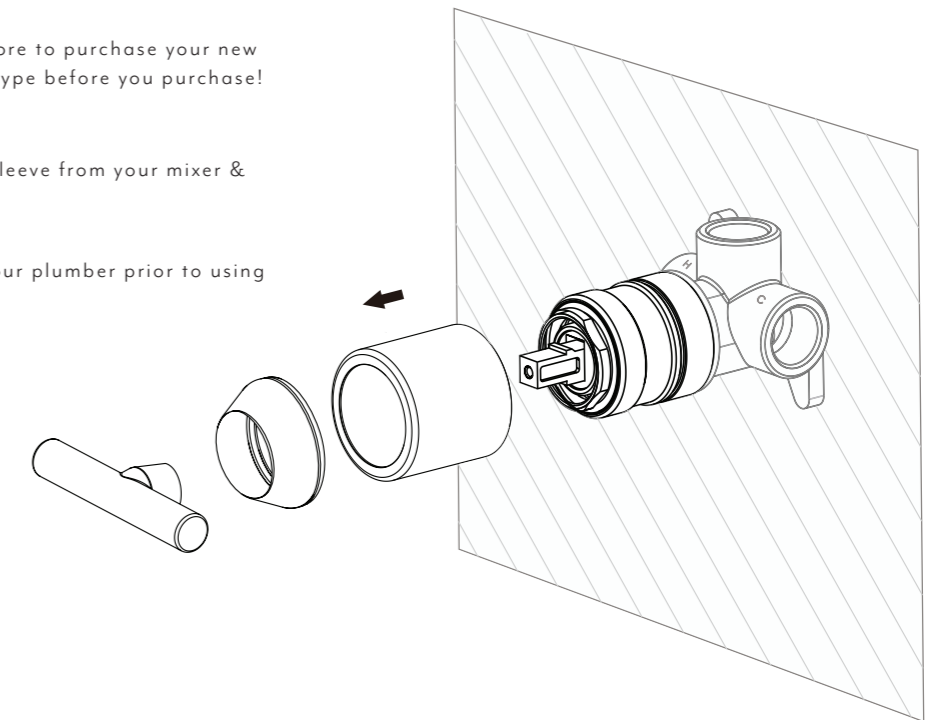

Regularly clean with mild liquid detergent or soap and water



DO NOT use cream cleaners or bleach. These substances are abrasive

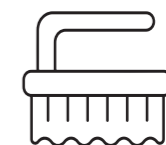

DO NOT use cleaning pads with abrasive surfaces as this may scratch the material