

ABI IN-WALL - ASSEMBLY TAPS - SPINDLE STANDARD SET (H&C) (SOLID BRASS) - AU/NZ

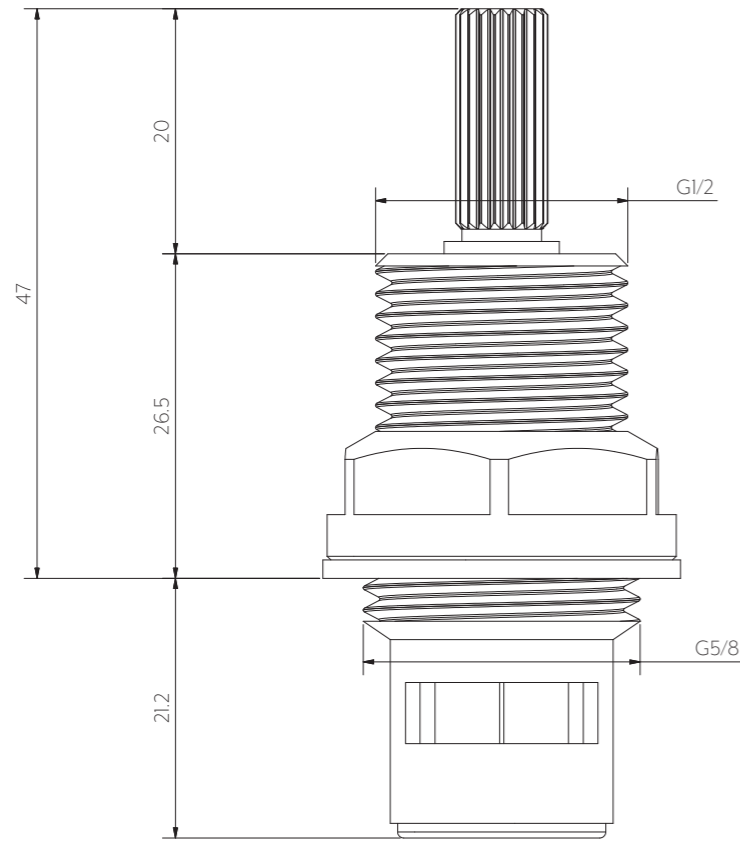

Front View

Note: Dimensions are nominal measurements only

SPECIFICATIONS

RECOMMENDED USE

Domestic

MATERIAL

Solid Brass

TEMPERATURE RATING

Maximum continuous working temperature 75°C
If the water temperature exceeds 75°C, an approved tempering valve must be fitted

PRESSURE RATING

Recommended minimum working pressure 150kPa
Recommended maximum working pressure 500kPa
Hot and cold water inlet pressure should be equal

FUNCTION

1/4 turn (clockwise & anti-clockwise spindle in set)

Disclaimer: Products in this specification manual must by regulation be installed by licensed and registered trade people. The manufacturer/distributor reserves the right to vary specifications or delete models from their range without prior notification. Dimensions are nominal measurements only. Dimensions and set-outs listed are correct at time of publication however the manufacturer/distributor takes no responsibility for printing errors. All ABI Products are designed in Australia. Copyright ABI Interiors Pty Ltd 2021.

INSTALLATION GUIDE

This product must be installed by a licensed plumber. This is a general installation guide - there are many factors that are involved that can alter the installation method. This product install must comply with AS/NZS 3500.

- 1 New Build**
Install breach in desired position

Retrofitting Existing

Remove existing tapware & reseal body seats until shiny & smooth. Remove locking nut and screw spindle into breach, hand tighten until rear of spindle meets the body seat. **Be sure not to overtighten.** If necessary apply more pressure lightly with a spanner.

*At this point it is recommended to test the orientation of your chosen handles. Micro adjustments can be made to spindle to ensure correct handle orientation before installing the locking nut.

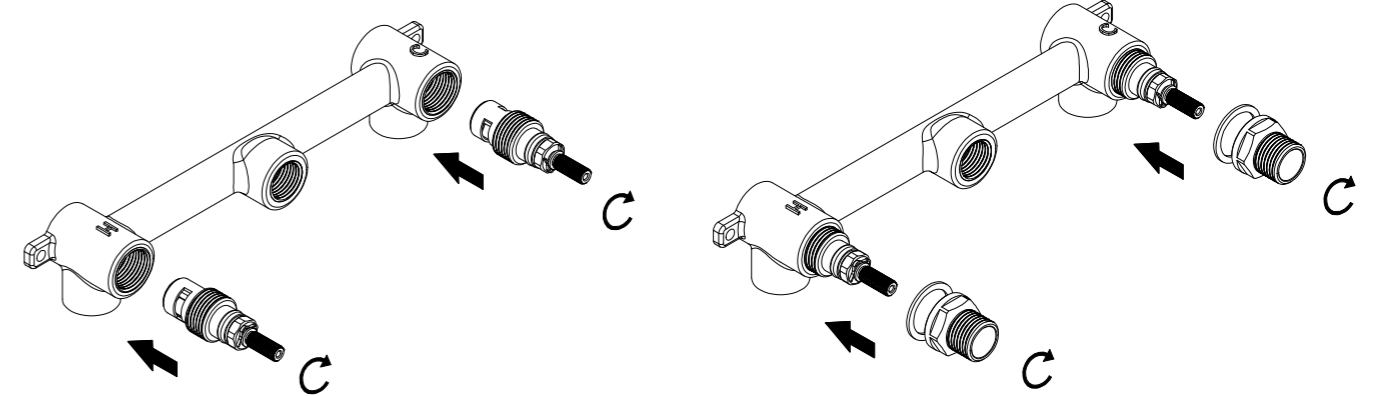

- 2** Place compression washer over spindle and screw on the locking nut, tightening with a spanner. **TEST AND COMMISSION. ENSURE THERE ARE NO LEAKS.**

- 3** Continue with the installation of the handles. See installation guide specific to your chosen handle design.

IN THE BOX

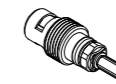

1x Hot spindle - Red
(turn clockwise on)



1x Cold spindle - Blue
(anticlockwise turn on)



2x Compression
Washer



2x Locking Nut



Regularly clean with mild liquid detergent or soap and water



DO NOT use cream cleaners or bleach. These substances are abrasive

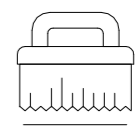

DO NOT use cleaning pads with abrasive surfaces as this may scratch the material