

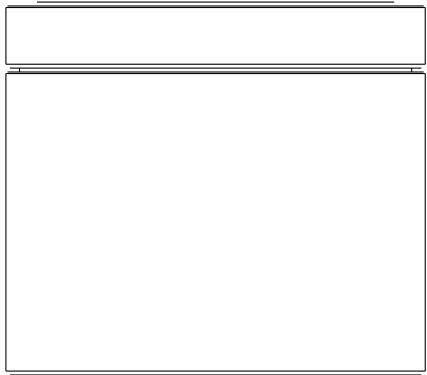

# MILANI ASSEMBLY HANDLE SET

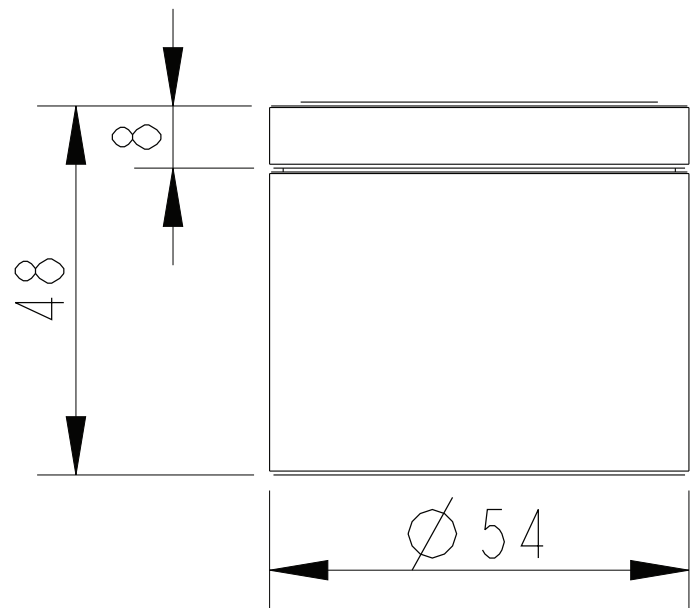

**Note:** Dimensions are nominal measurements only

## SPECIFICATIONS

### RECOMMENDED USE

Domestic

### CONSTRUCTION

Solid Brass

Disclaimer: Products in this specification manual must by regulation be installed by licensed and registered trade people. The manufacturer/distributor reserves the right to vary specifications or delete models from their range without prior notification. Dimensions are nominal measurements only. Dimensions and set-outs listed are correct at time of publication however the manufacturer/distributor takes no responsibility for printing errors. All ABI Products are designed in Australia. Copyright ABI Interiors Pty Ltd 2021.

## INSTALLATION GUIDE

Note: This product must be installed by a licensed plumber.  
This is a general installation guide - there are many factors that are involved that can alter the installation method.

1

**New Build**  
Install breach in desired position.

**Retrofitting Existing**  
Remove existing tapware & reseal existing body seats until shiny & smooth.  
Screw spindle into breach and hand tighten until rear of spindle meets the body seat, **be sure not to overtighten**.  
If necessary apply more pressure lightly with spanner.  
(Note: Locking nut must be removed prior to installing this part of the spindle)

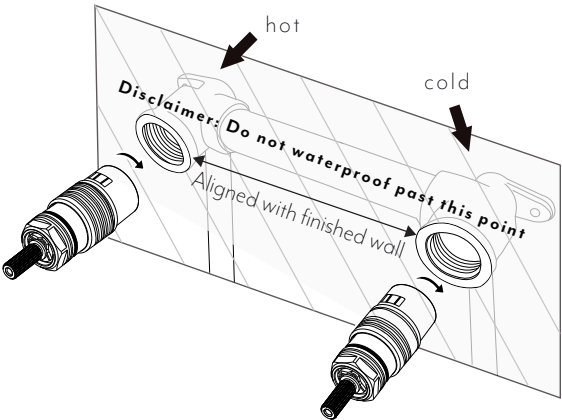

2

Fit the fibre washer over the spindle.  
Screw on the locking nut and tighten with spanner.  
**TEST AND CHECK FOR LEAKS**

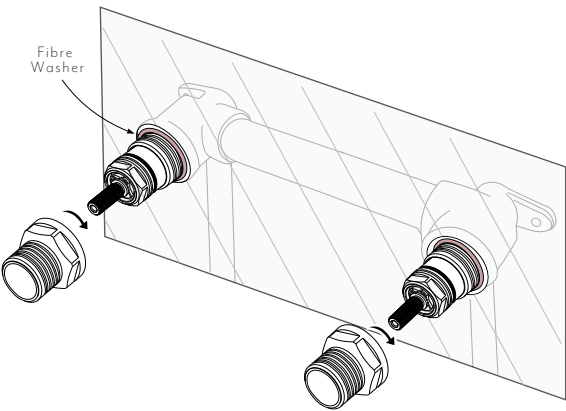

3



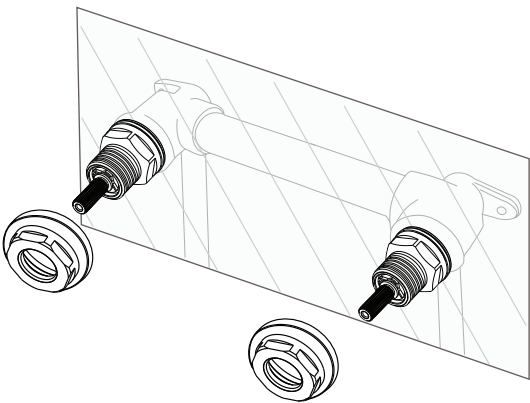



Screw the back plate onto the spindle and tighten

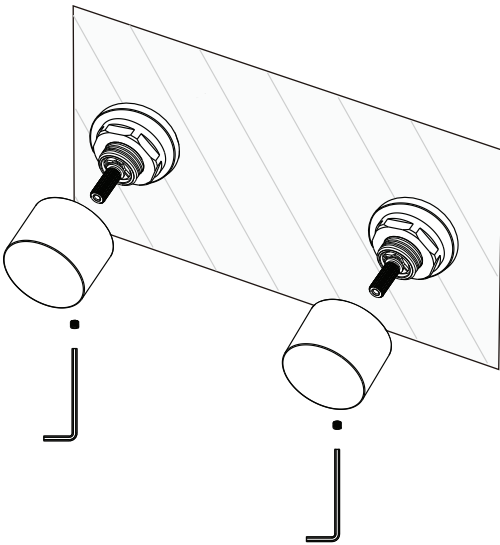

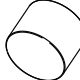
4

Install handle by using the allen key provided and tighten grub screw.

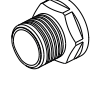

IN THE BOX					
BOX 1			BOX 2		
					
2x Handles	2x Dress Plates	1x Allen Key	2x Spindles	2x Locking Nuts	2x Fibre Washer

\*Extended spindle available on our website

TYPICAL ASSEMBLY TAP EXAMPLES

Note: This product must be installed by a licensed plumber.  
This is a general installation guide - there are many factors that are involved that can alter the installation method.



Example One:  
Offset basin mixer/bath spout setup

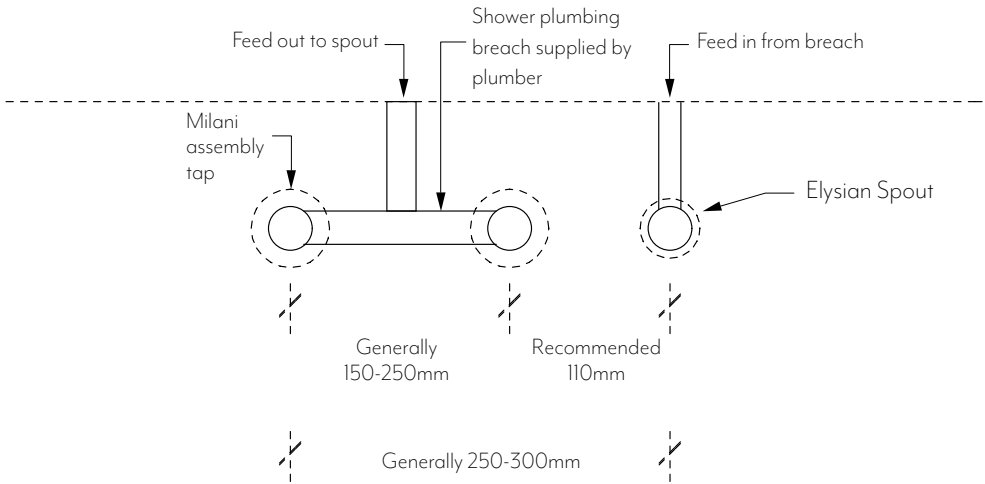

Example Two:  
Centred basin mixer/bath spout setup

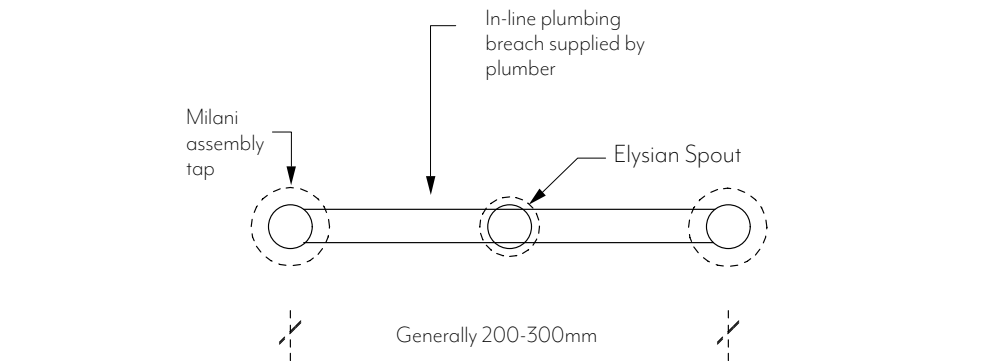

Example Three:  
Shower Setup

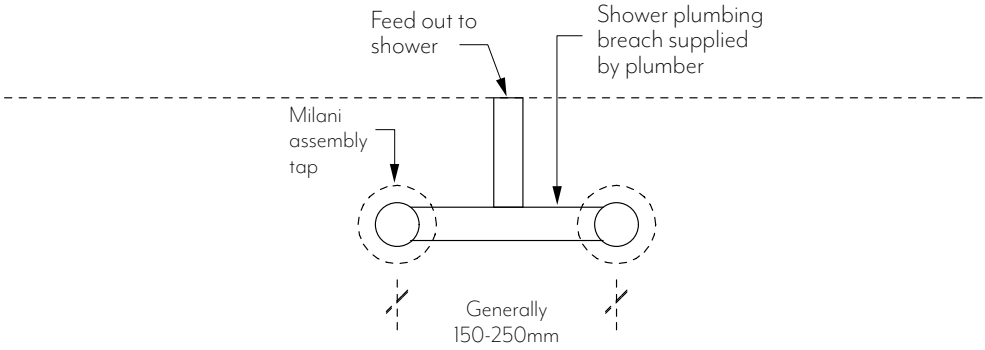

INSTALLATION GUIDE

Note: This product must be installed by a licensed plumber.  
This is a general installation guide - there are many factors that are involved that can alter the installation method.

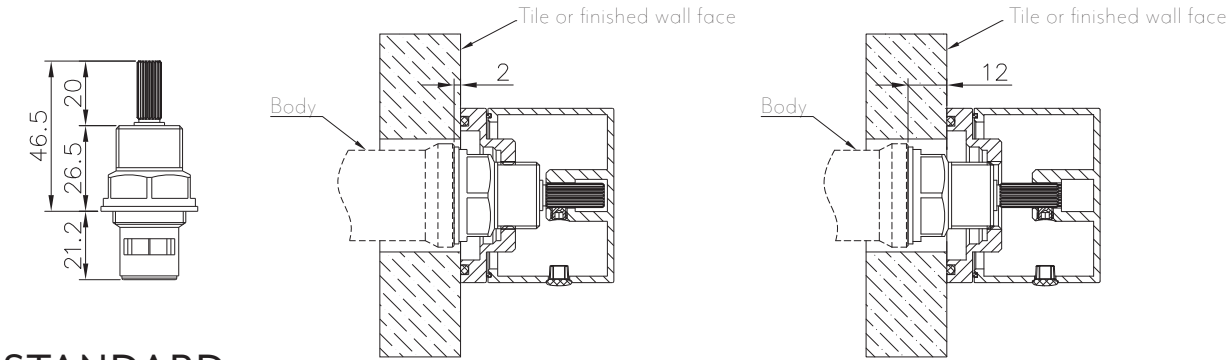

STANDARD

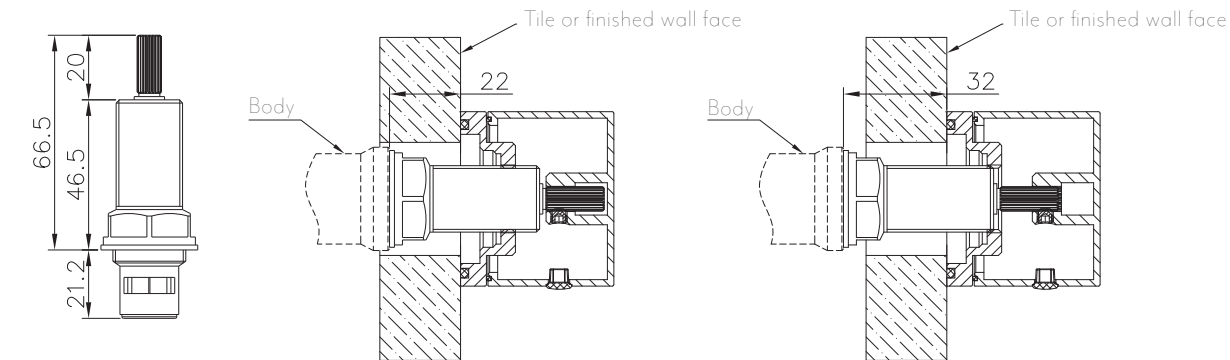

EXTENDED

EXPLODED VIEW

- Item Description Code
- 1-2 Spindle
  - 3 O-Ring
  - 4 Body
  - 5 O-Ring
  - 6 Handle
  - 7 Grub Screw
  - 8 Cap
  - 9 Grub Screw
  - 10 Allen Key

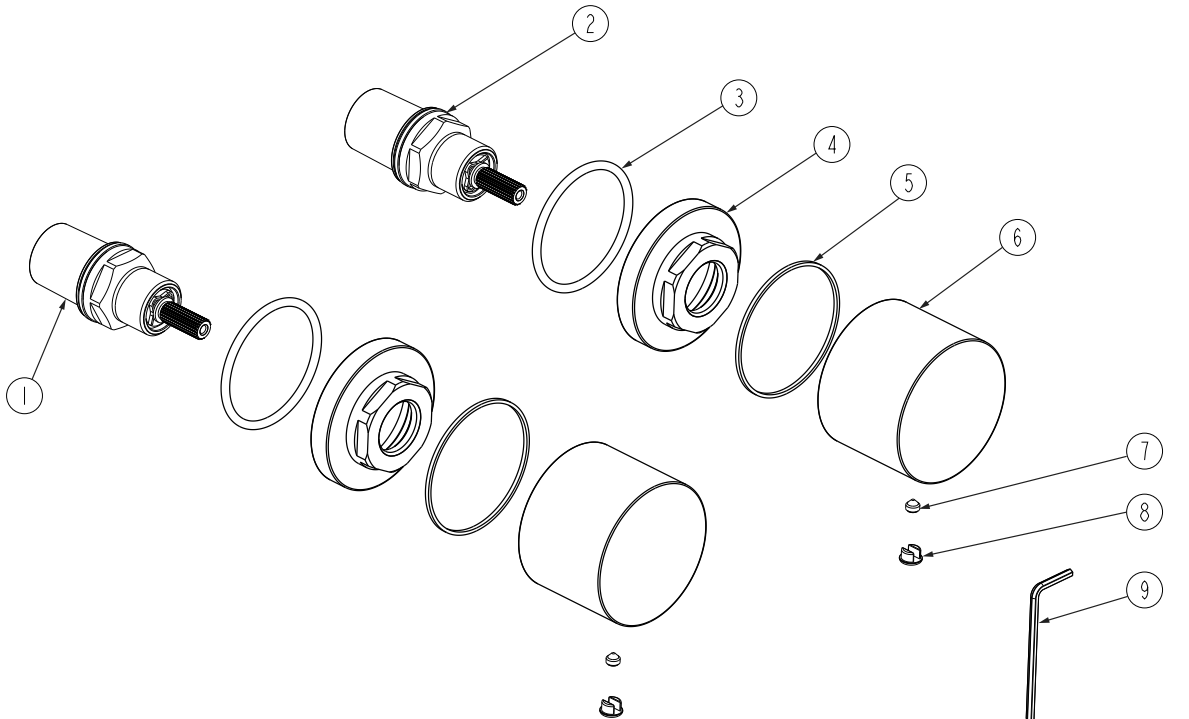

Regularly clean with mild liquid detergent or soap and water



DO NOT use cream cleaners or bleach. These substances are abrasive

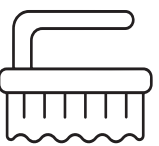

DO NOT use cleaning pads with abrasive surfaces as this may scratch the material