

Top View

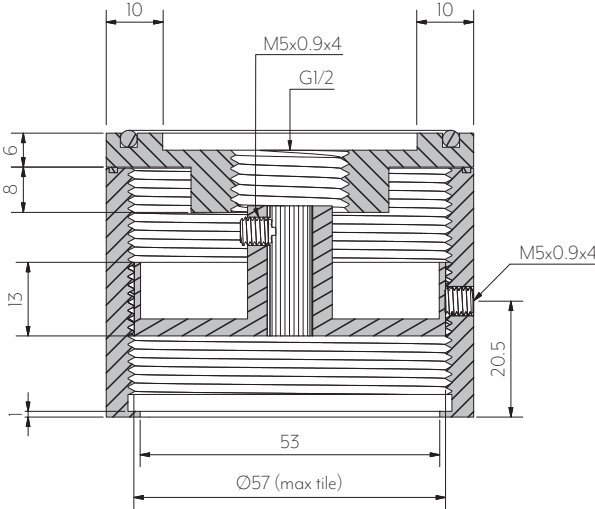

A-A

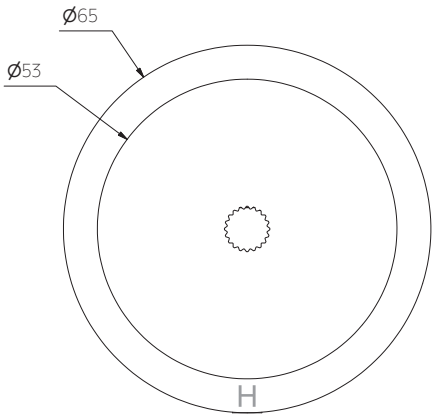

Front View

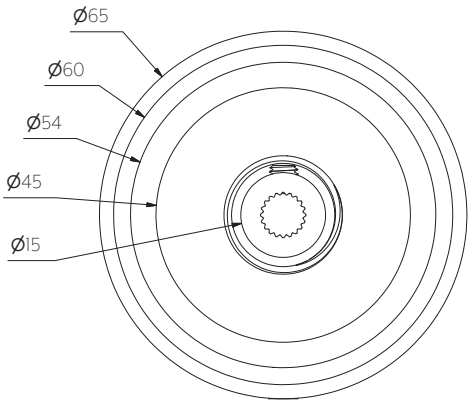

Back View

Note: Dimensions are nominal measurements only

SPECIFICATIONS

RECOMMENDED USE

Domestic

CONSTRUCTION

Solid Brass

Disclaimer: Products in this manual must by law be installed by licensed and registered tradespeople in accordance with the relevant standards. ABI and the manufacturer/distributor reserve the right to vary specifications or delete models from their range without prior notification. Dimensions are nominal measurements only. The information listed is correct at the time of publication, however ABI and the manufacturer/distributor takes no responsibility for printing errors. Copyright © ABI Interiors 2021.

INSTALLATION GUIDE

Note: This product must be installed by a licensed plumber.
This is a general installation guide - there are many factors that are involved that can alter the installation method. This product install must comply with AS/NZS 3500.

IMPORTANT: Spindle set backs are critical, refer to following pages for more details

- 1

Screw backplate on to spindle & tighten firmly.
- 2

Mount spindle attachment to spindle.* **IMPORTANT:** Ensure spindles are in the off position, turn clockwise to turn off cold and anti-clockwise for hot

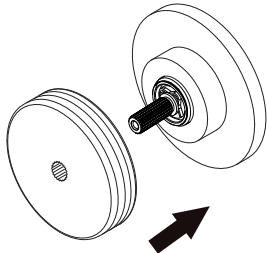
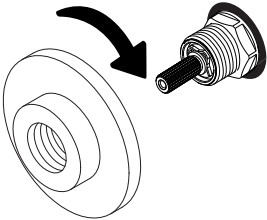

- 3

Place cut tile on face of spindle attachment and push both back and forth to align tile face with the face of the handle. Tile face should finish 43mm from face of base plate.

- 4

1. Remove tile from spindle attachment.
2. Fix spindle attachment into position by inserting and tightening M5 grub screw using allen key provided.

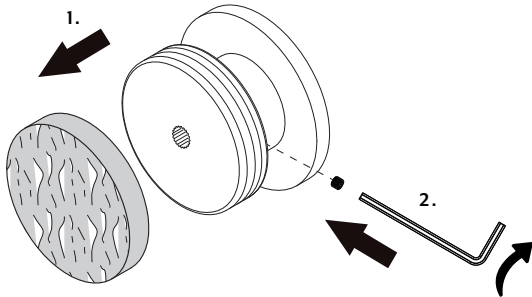
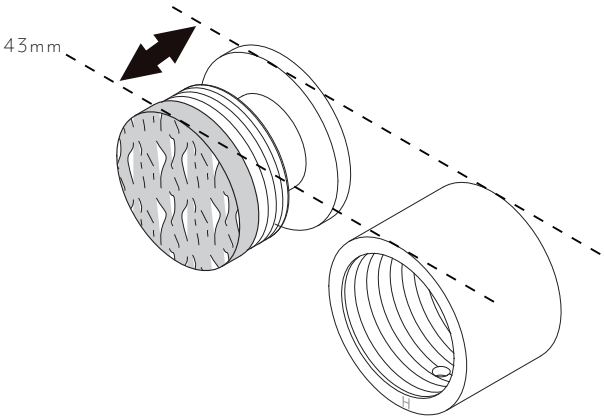

- 5

Put a small amount of silicone on the front perimeter of the tile and push into handle and screw both on to base plate.

- 6

1. Screw handle on to spindle attachment, while holding then tile in disired position.
2. Fix handle into postion by inserting and tightening the grub screw using allen key provided.

How to orientate H/C sybmbol.
At this point note where the symbol is located when the handle is in the off position. Mark with a pencil the position it needs to be. Return to step 2 and adjust the base plates orientation by the referenced amount.

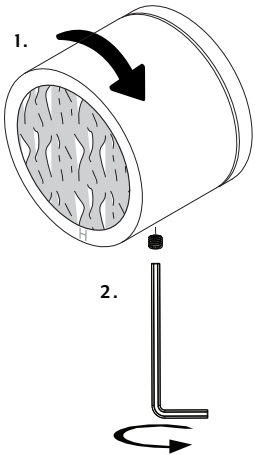
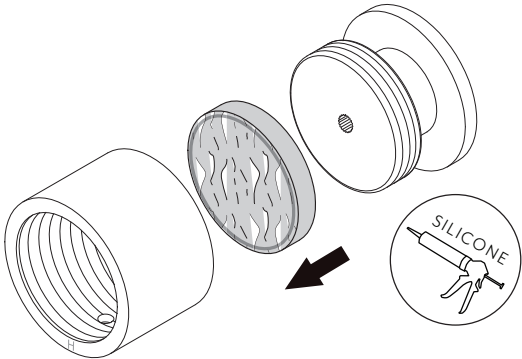

IN THE BOX						
	2x Handles	2x Backplate	2x Spindle Att.	1x Diamond Hole Saw	1x 5mm Allenkey	4x M5 Grub Screw



Regularly clean with mild liquid detergent or soap and water



DO NOT use cream cleaners or bleach. These substances are abrasive



DO NOT use cleaning pads with abrasive surfaces as this may scratch the material

INSTALLATION GUIDE

Note: This product must be installed by a licensed plumber.
This is a general installation guide - there are many factors that are involved that can alter the installation method. This product install must comply with AS/NZS 3500.

How to cut your tile insert

HOLE SAWS ARE INCLUDED WITH TAPS

60mm Diamond Hole Saw
SKU: 15206

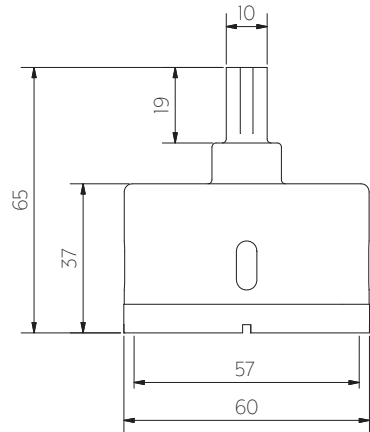

Front View

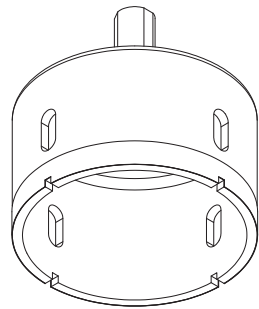

Isometric View

- 1 **Drill press:** we highly recommend getting a professional to cut your tile using a drill press.
- 2 **Hand drill:** we do not recommend using this method unless you are highly experienced.

Using the provided 60mm diamond hole saw, drill incrementally deeper into your tile until through.

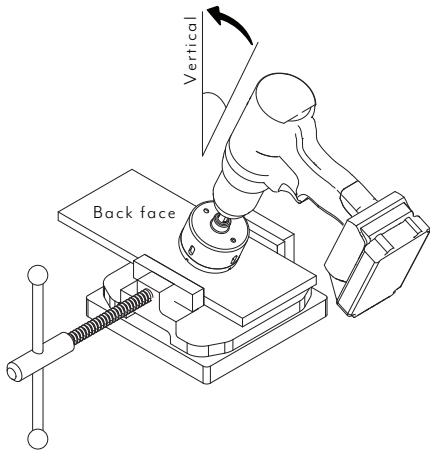
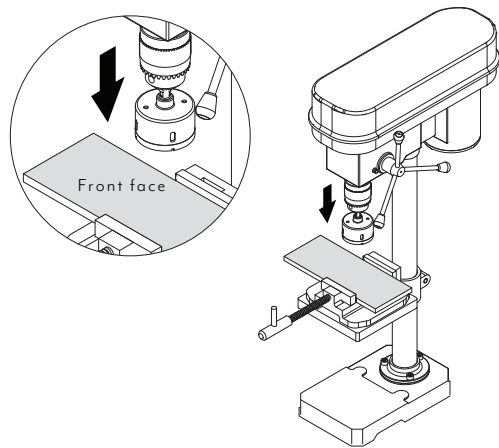

Work from the back face of the tile. Start the drill on an angle so it is easier for the hole saw to bite, then slowly bring the saw vertical.



SET BACK GUIDE

Note: See set back table on next page for more details

MINIMUM

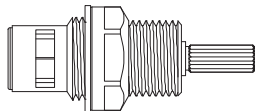
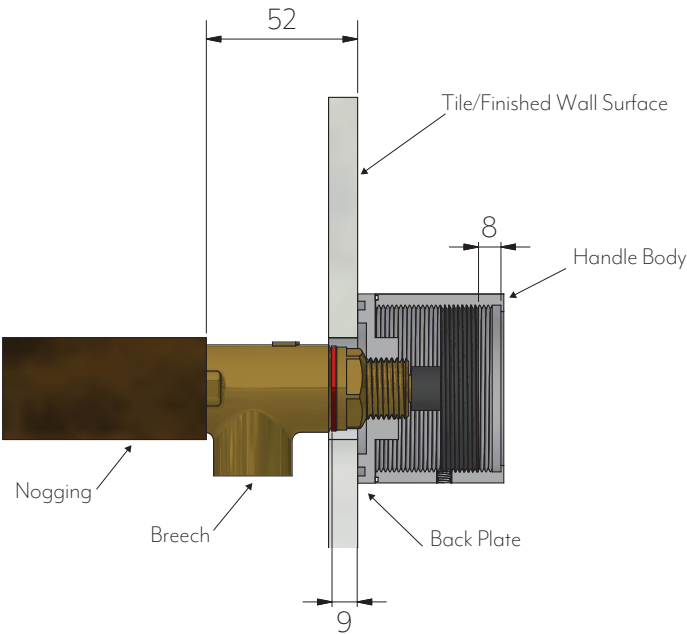

standard spindle

Minimum distance between nogging and finished wall surface is 52mm
The maximum insert thickness will decrease to 8mm for this set back (or 9mm from in-wall breach to finished wall surface).

MAXIMUM

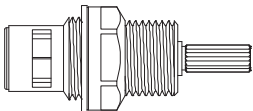
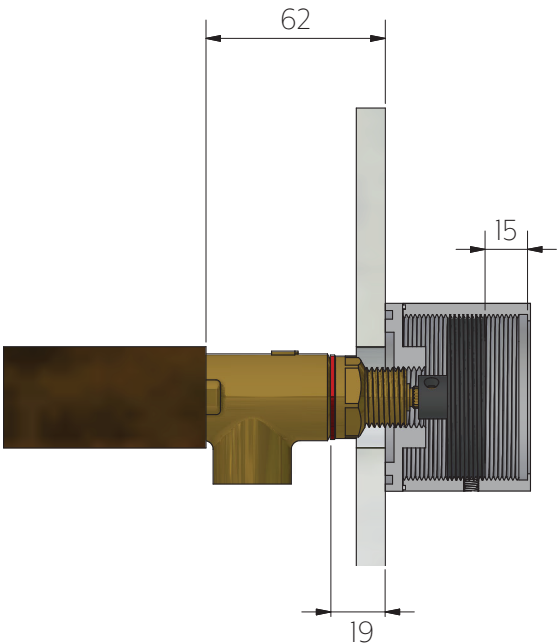

standard spindle

Maximum distance between nogging and finished wall surface is 62mm
The maximum insert thickness will be at 15mm for this set back (or 19mm from in-wall breach to finished wall surface).

MINIMUM

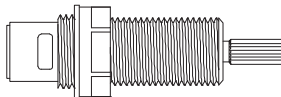
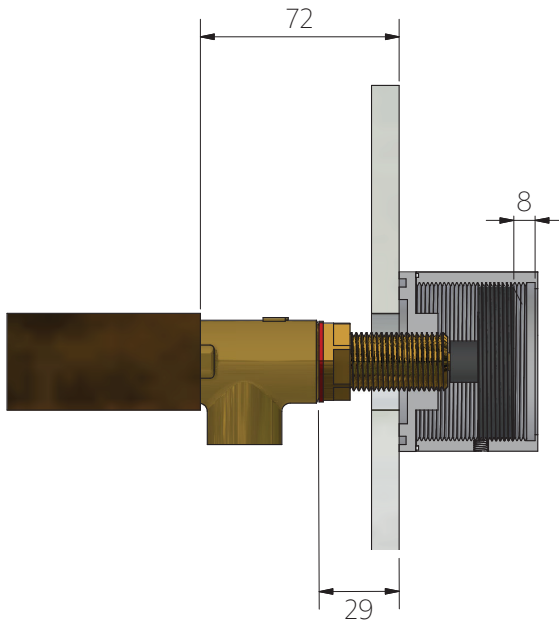

extended spindle

Minimum distance between nogging and finished wall surface is 72mm
The maximum insert thickness will decrease to 8mm for this set back (or 29mm from in-wall breach to finished wall surface).

MAXIMUM

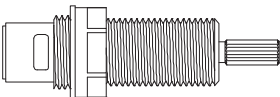
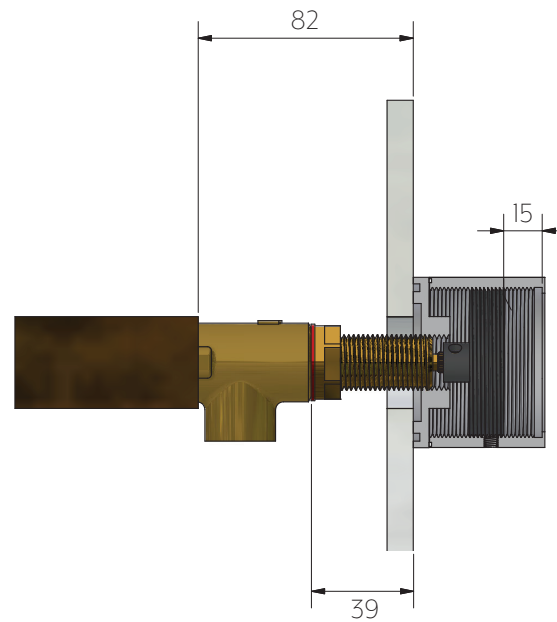

extended spindle

Minimum distance between nogging and finished wall surface is 82mm
The maximum insert thickness will be at 15mm for this set back (or 39mm from in-wall breach to finished wall surface).



INSTALLATION GUIDE

Note: This product must be installed by a licensed plumber.
This is a general installation guide - there are many factors that are involved that can alter the installation method. This product install must comply with AS/NZS 3500.



Set Back Range for tile thickness

Note: Thicker tiles have decreased range

Tile Thickness	Standard Spindle	Extended Spindle
5mm TILE	52-62	69-80
6mm TILE	52-62	70-81
7mm TILE	52-62	71-82
8mm TILE	52-62	72-82
9mm TILE	53-62	73-82
10mm TILE	54-62	74-82
11mm TILE	55-62	75-82
12mm TILE	56-62	76-82
13mm TILE	57-62	77-82
14mm TILE	58-62	78-82
15mm TILE	59-62	79-82

